

If your unit is not getting a pilot, you may have a blockage. Here are a few easy steps to assist in cleaning out your pilot feed tube.

## How to Clean out the Pilot Feed Tube in a Tall Standard Heater

Be sure to have these tools handy.



# STEP 1

# 1

DISASSEMBLE



**Locate the four screws on the base of your burner emitter screen. These are generally located under the mesh part as shown. Remove these screws, the screen and the shield, will come off.**

# STEP 1

DISASSEMBLE

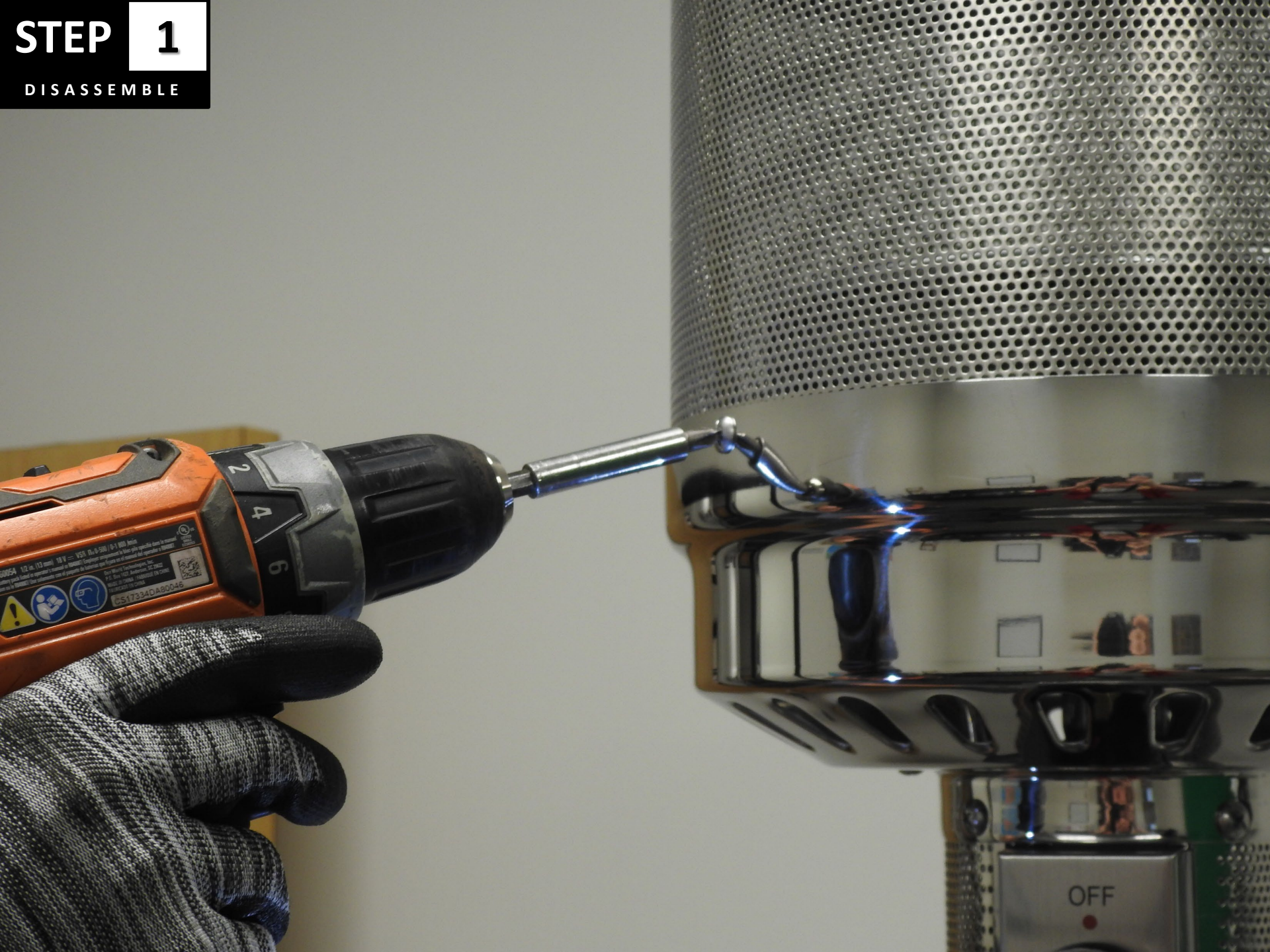

**STEP 2**  
DISASSEMBLE

Locate the four screws above the control knob and remove. This will allow you to pull your burner out.



# STEP 2

DISASSEMBLE



# STEP 3

DISASSEMBLE



Pull the burner out and allow to hang by the hose through the mesh opening

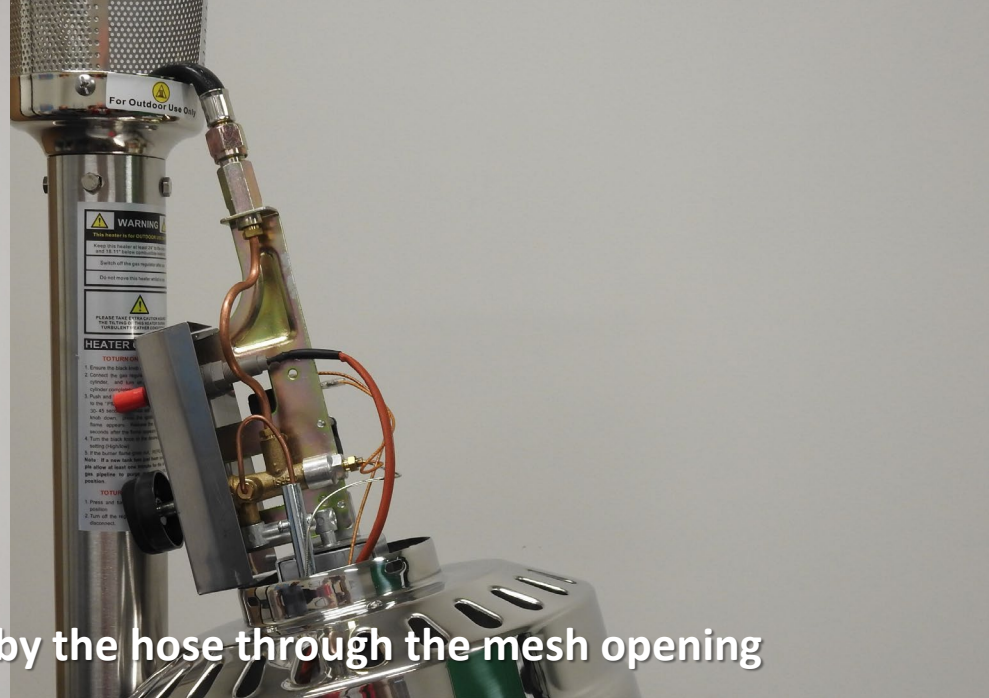

# STEP 4

PILOT CLEAN

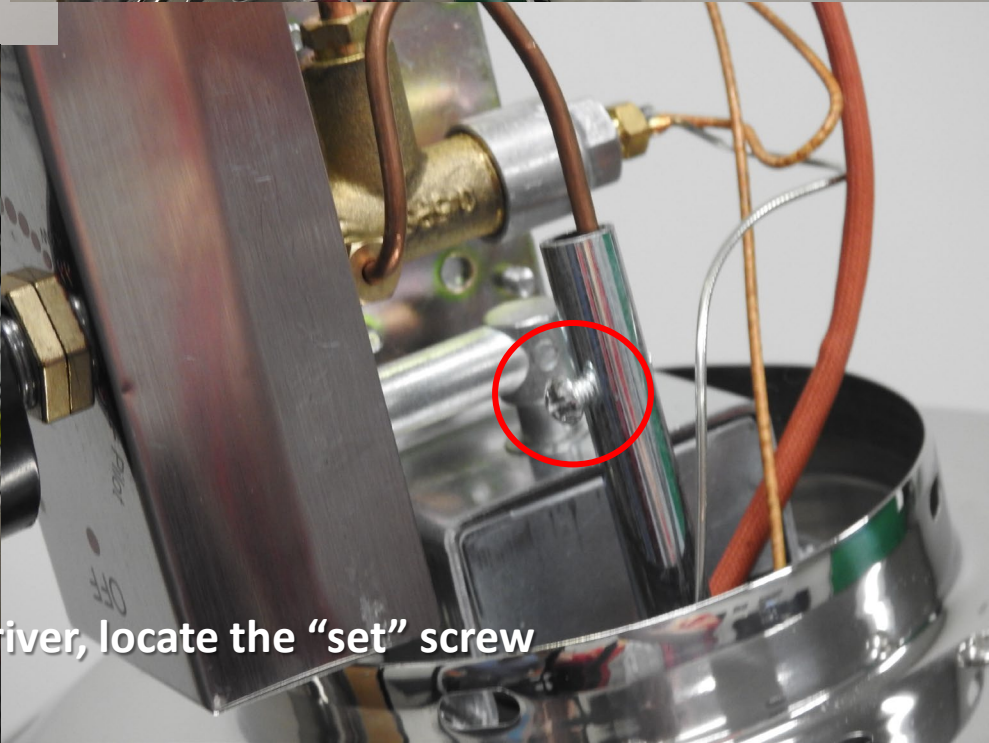

Using a Philipps screwdriver, locate the "set" screw

**STEP 4**

**PILOT CLEAN**

**TOTUR**

ess and turn  
osition  
urn off the regu  
sconnect.

Loosen the "set" screw up, being careful not to fully remove it



**STEP 5**  
PILOT CLEAN

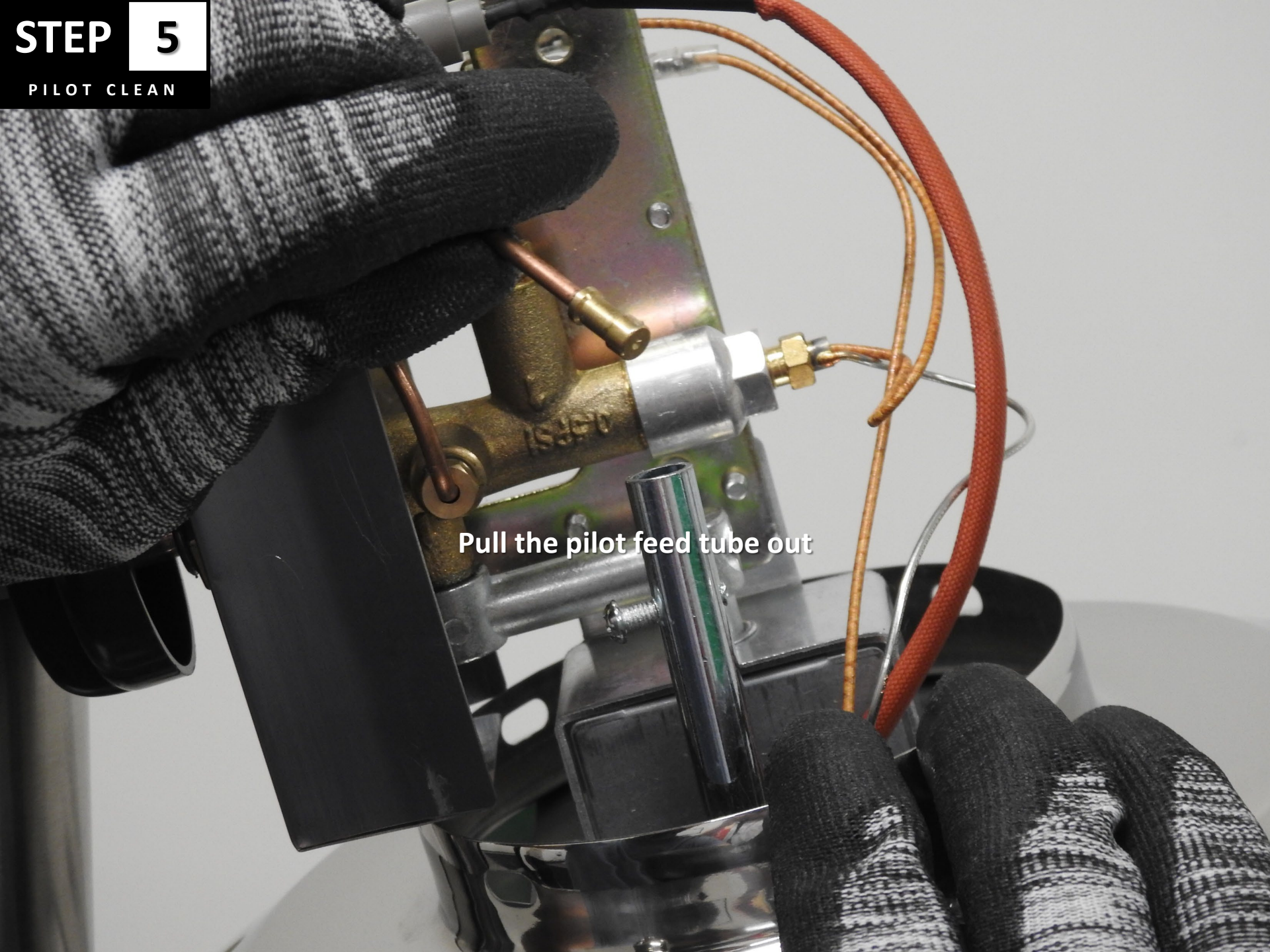

Pull the pilot feed tube out



**STEP 6**  
PILOT CLEAN



Take a zip tie and clean out the venturi tube from both directions

**STEP 6**  
PILOT CLEAN



**STEP 6**  
**PILOT CLEAN**



NOTE: If needed, use an air compressor to remove larger debris



**STEP 7**  
PILOT CLEAN



Grab some pliers and remove the pilot feed tip

**STEP 7**  
PILOT CLEAN

Unscrew the tip using pliers. Make sure you are holding the tube tightly with your hand or another pair of pliers



**STEP 7**  
PILOT CLEAN



**STEP 7**  
PILOT CLEAN



Take an air compressor and clean out the tip of the pilot feed tube, making sure to clean both sides of tip

**STEP 7**  
PILOT CLEAN





# STEP 8

PILOT FLOW

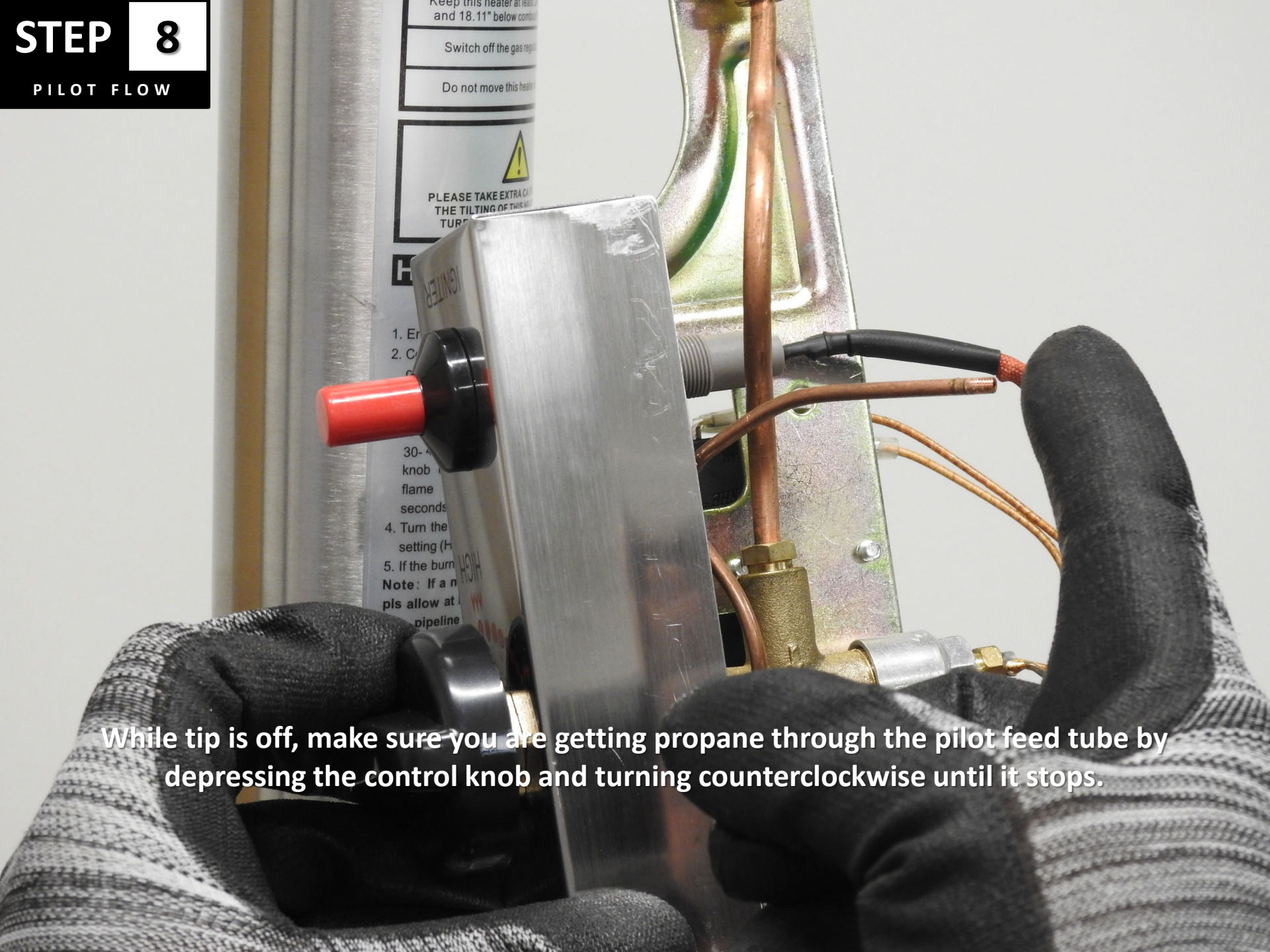

Keep this heater at least 18.11" below combustion  
Switch off the gas regulator  
Do not move this heater

**PLEASE TAKE EXTRA CARE TO AVOID THE TILTING OF THIS HEATER. TURN THE HEATER TO THE UPRIGHT POSITION.**

1. Er  
2. C  
30-  
knob  
flame  
seconds  
4. Turn the  
setting (H  
5. If the burn  
**Note:** If a n  
pls allow at  
pipeline

While tip is off, make sure you are getting propane through the pilot feed tube by depressing the control knob and turning counterclockwise until it stops.

**STEP 9**  
DIFFUSER  
CLEAN

Clean out the diffuser plate with  
compressed air to remove dirt / debris



**STEP 10**  
TEST PILOT

Test the pilot flame by placing the burner on the mesh screen. The pilot should be a nice blue flame as shown

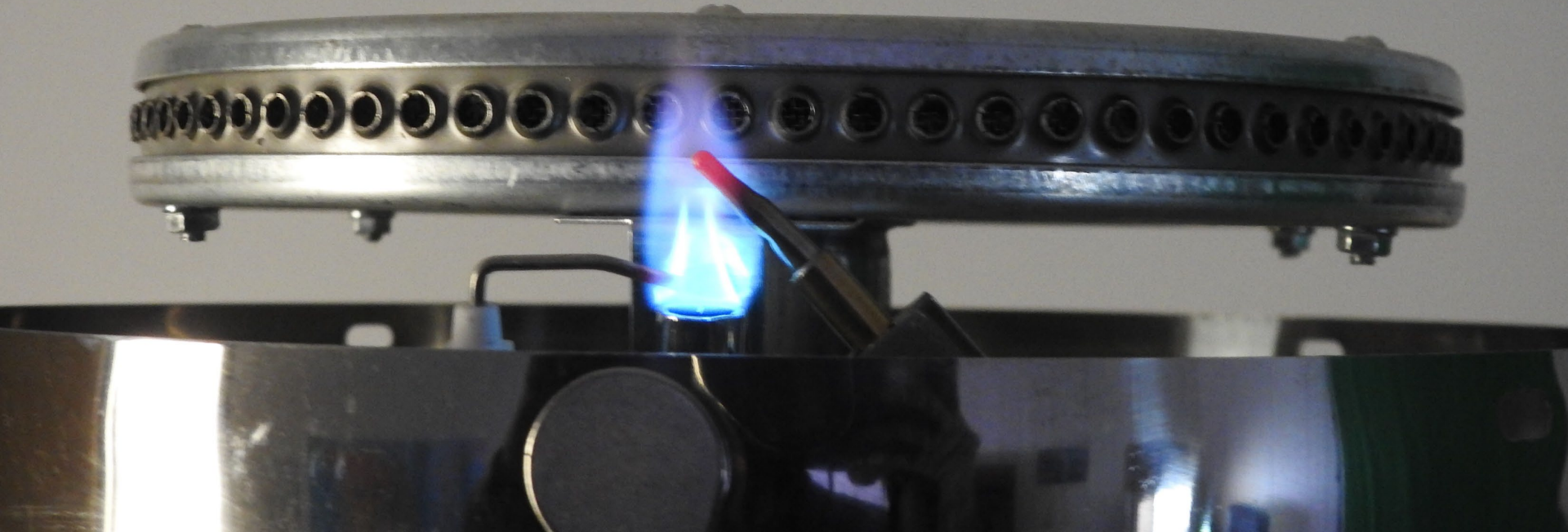

**ALL FINISHED**

REASSEMBLE



Tighten the burner back into place with the four screws

**ALL FINISHED**

REASSEMBLE



Reattach the burner screen and shield with the four screws



**For issues with the pilot not staying on, please click below**

**[Tutorials and PDFs](#)**

**Click below to order parts**

**[Tall Patio Heater Parts](#)**